



V

THE VIBE

BODRUM

*a new wave of living!*





*Come to life in a  
different dimension,  
in the heart of  
Bodrum*



2 | Site Location | *The Vibe*





*Where your legacy  
finds a home*

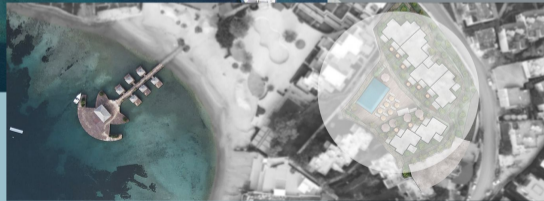

#### 4 | Site Location | *The Vibe*

Yalikavak is 18 km from Bodrum. It is located in the northwest of the peninsula. On a journey from Bodrum to Yalikavak, first a row of windmills and then the unique view of Yalikavak welcomes you. Yalikavak, has turned into a very important tourism resort today. It stands out with its windmills on the hills and the coast, beautiful coves, sunsets and tourism facilities opened in recent years. The Vibe is 50km from Bodrum airport, 3km from Yalikavak Marina and 20km from Bodrum city center.

PROVINCE: MUĞLA DISTRICT  
ROAD: TILKİCİK  
PARCEL: 8

BODRUM QUARTER: GÖKÇEBEL  
BLOCK: 712  
AREA SURFACE: 77.7932 M2

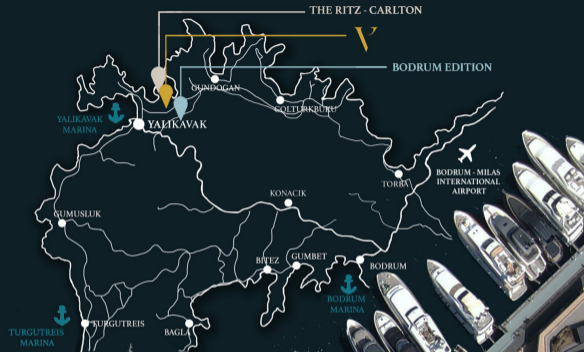

## Hotspots

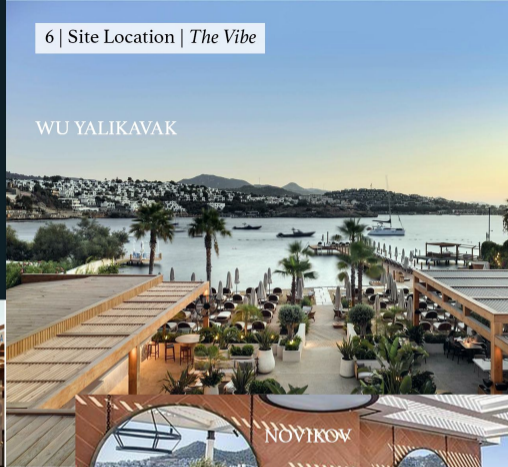
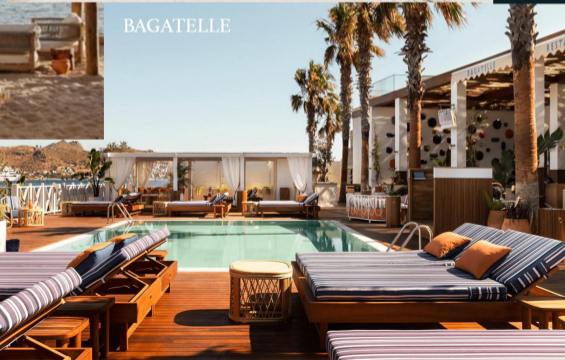
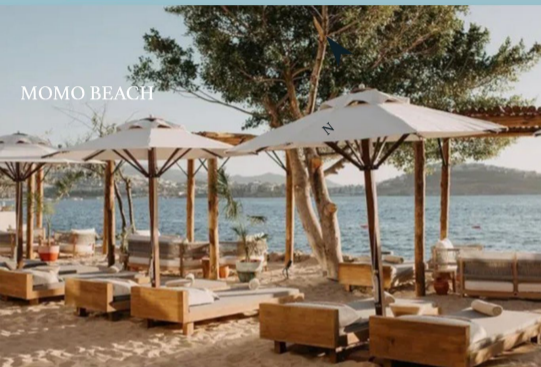

6 | Site Location | *The Vibe*

WU YALIKAVAK

ZUMA

*The Vibe Bodrum is a short ride away from Bodrum's trendiest hotspots.*



## Beach access



*More than a stunning island setting, The Vibe encapsulates a vibrant island lifestyle with breath-taking views and a direct beach access. The Vibe is the ideal residence, with a stunning beachfront setting in the beating heart of one of the most dynamic cities, Bodrum.*

*Where the city meets the sea, experience the magic of the vibe*



## 8 | Site Location | *The Vibe*



Pool view from the terrace



*Grand views, fresh air & lavishness*

10 | Sigh | *The Vibe*

Gate entrance



*Get used to an environment where  
everything goes your way*

**NEXT**  
PROPERTY

Bloc C pool view



*Serenity, greenery & peaceful stay*

12 | Sigh | *The Vibe*

Bloc E pool view



*Space, pride & exclusivity*



Global view



14 | Sigh | *The Vibe*

Bloc E | Zoomed in elevation

*Enjoy the spectacular views, an abundance of  
sunlight through the large windows*

## Ground floor



*Whichever unit you select at The Vibe, recognize that you are joining an exclusive community of residents*

## First floor



## 16 | Plans | The Vibe

## Second floor



*Both bloc C and bloc E give astonishing view access to the greenery and the pool from all levels with the different unit types A and B, making it functional aesthetic both at once*

## Bloc C



*The rooms boast an airy layout and luxurious yet relaxing interiors adding to your comfort and experience.*

■ TYPE A I+I ‘  
■ TYPE A I+I “



	App Type	Nb of App	Nb of Floor	Nb of Rooms	Type of Rooms	Size of Rooms	Size of App
Bloc C	A I+I ‘	2	GF FF SF	5	ENTRANCE BEDROOM LIVING ROOM KITCHEN BATHROOM	5.29 M2 15.31 M2 21.29 M2 8.20 M2 5.18 M2	56.37 M2
	A I+I “	2		5	ENTRANCE BEDROOM LIVING ROOM KITCHEN BATHROOM	3.35 M2 13.88 M2 23.93 M2 7.70 M2 6.49 M2	55.04 M2

TYPE A I+I ‘



*Type A plans offer a spacious living room, a separated luxurious bedroom and features an open*

TYPE A I+I “



## Bloc E

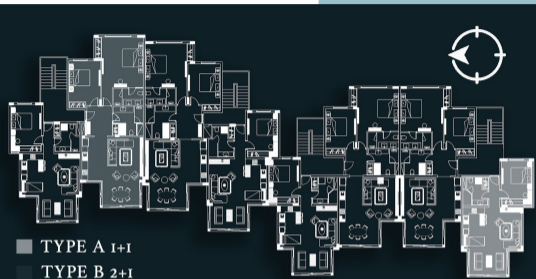

■ TYPE A 1+1  
■ TYPE B 2+1

	App Type	Nb of App	Nb of Floor	Nb of Rooms	Type of Rooms	Size of Rooms	Size of App
Bloc E	A 1+1	4	GF FF SF	5	ENTRANCE BEDROOM LIVING ROOM KITCHEN BATHROOM	3.35 M <sup>2</sup> 14.11 M <sup>2</sup> 24.42 M <sup>2</sup> 8.50 M <sup>2</sup> 5.48 M <sup>2</sup>	56.06 M <sup>2</sup>
	B 2+1	4		7	ENTRANCE MASTER BEDROOM MASTER BATHROOM BEDROOM LIVING ROOM KITCHEN BATHROOM	8 M <sup>2</sup> 24.06 M <sup>2</sup> 5.10 M <sup>2</sup> 14.93 M <sup>2</sup> 16.89 M <sup>2</sup> 8.89 M <sup>2</sup> 7.12 M <sup>2</sup>	94.69 M <sup>2</sup>

TYPE A 1+1



*The Location of every single unit has been carefully planned and positioned so that you can enjoy either the green view, the sea view, or some combination of all.*

TYPE B 2+1



*Type B offers in addition, a master bedroom and a dining room.*

TYPE A  
Living Room



22 | Interior | *The Vibe*

*Our efficiently designed apartments  
create convenient living, comfortable and  
spacious life for you and your family. All in  
the mindset of breathtaking natural beauty.*



TYPE A

Terrace

*Wake up to a majestic view of greens, the sea, a lifestyle that is most desired but few have the privilege to own*



24 | Interior | *The Vibe*

Living Room

*Touch life, comfort and convenience*

**NEXT**  
PROPERTY



TYPE A and B  
Bedroom

*Bedroom that redefine the language of luxury*



26 | Interior | *The Vibe*

Bedroom

*Spacious and updated rooms offering the perfect mix of comfort and amenities*

TYPE B  
Living Room

Experience a superior level of comfort  
with our rooms furnished with  
elegantly appointed interiors and  
relaxing ambience

28 | Interior | *The Vibe*



TYPE B

Living Room



*Splendor, elegance and brightness  
within a luxury lifestyle*

30 | Interior | The Vibe

Living Room



*A balanced combination of clean, modern  
materials inviting the light to flow*

TYPE B  
Bedroom

*Wooden elements juxtaposed with the silver coolness of modern appliances, capturing the initial idea of “minimal but inviting” in all its glory.*

32| Interior | The Vibe

Bedroom

*Deluxe rooms, spacious, well appointed and furnished in style.*

TYPE A and B

Bathroom



*Curated modern bathroom decorations helping to achieve an inviting feel.*

34| Interior | *The Vibe*

Bathroom



*The design is sleek and modern, keeping up with the space's overall aesthetic.*

**NEXT**  
PROPERTY

# NEXT PROPERTY

## Cooperation companies



The photos on this catalogue are for informational purposes only. The Vibe Bodrum reserves the right to make adjustments therein without prior notice.



+90 545 8353536

+90 537 4932774

[www.thevibebodrum.com](http://www.thevibebodrum.com)

[info@thevibebodrum.com](mailto:info@thevibebodrum.com)

**NEXT**  
PROPERTY